

ISLAND SERIES
40m 300 Passenger Ferry



AMT

AUSTRALIAN MARINE TECHNOLOGY

ISLAND SERIES

High Speed 40m 300 Passenger Ferry

VESSEL APPLICATIONS: Passenger and Cargo transfer both inter island and International voyages throughout the Pacific region, Crew transfer, Dive and ROV support, Survey and Seismic operations, Evacuations and Medevac response, Standby operations, medevac, etc.

- ✓ High speed mono hull design for better sea keeping and passenger comfort.
- ✓ Built to International Classification meeting the highest safety standards.
- ✓ High back passenger seating across all fully air-conditioned decks.
- ✓ Dedicated cargo area allowing a combination of cargo and passengers.

ISLAND SERIES

High Speed 40m 300 Passenger Ferry

Design: Australian Marine Technology P/L

Builder: MOC Shipyards Pvt Ltd

Classification: +100AI, HSC, Passenger (A) Mono, HSC, G4 LMC

Flag: TBA

Passenger & crew: 300 + 10 crew

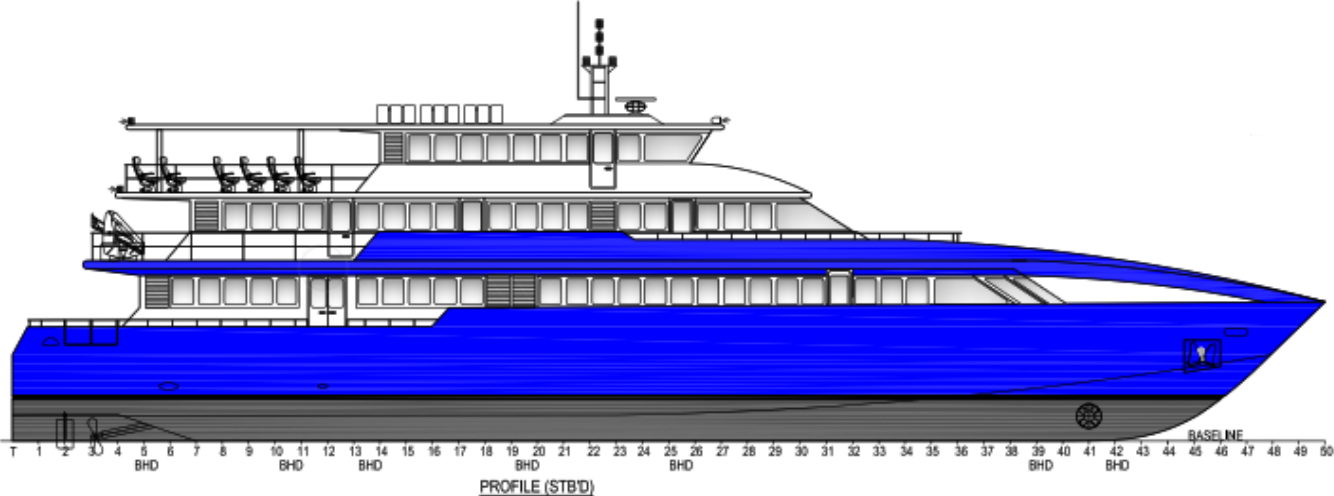

Crew accommodation, galley and mess

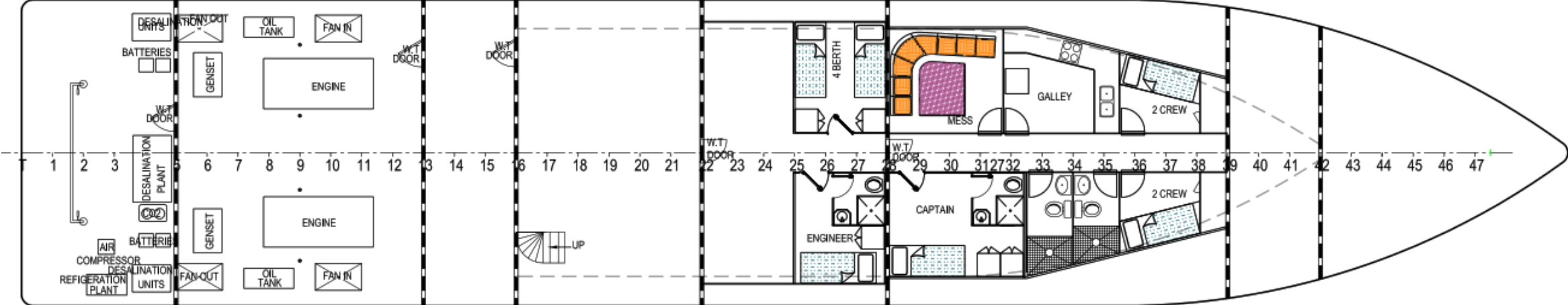

BELOW DECK PLAN

ISLAND SERIES

High Speed 40m 300 Passenger Ferry

Main Deck: Cargo area, 127 passengers fully air-conditioned, kiosk and 4 x toilets

Top Deck (01 Deck): 113 passengers fully air-conditioned, toilet, tender vessel and launching davit.

Bridge Deck: 32 internal passengers fully air-conditioned and 32 external passengers under shade awning

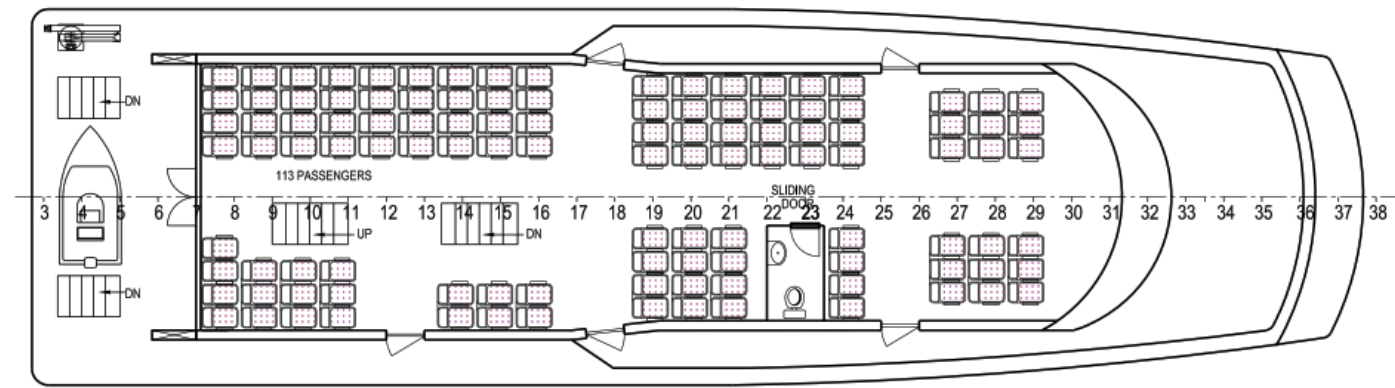

TOP DECK PLAN (01 DECK)

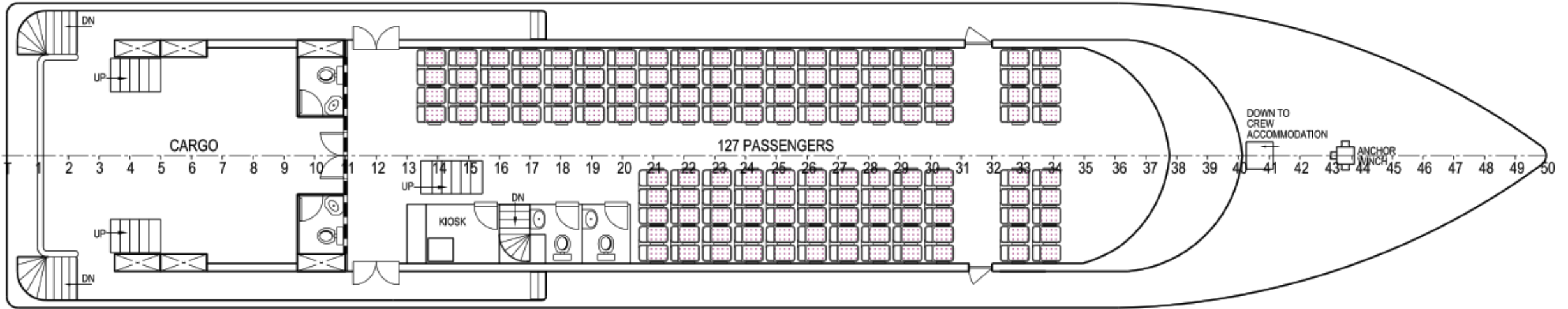
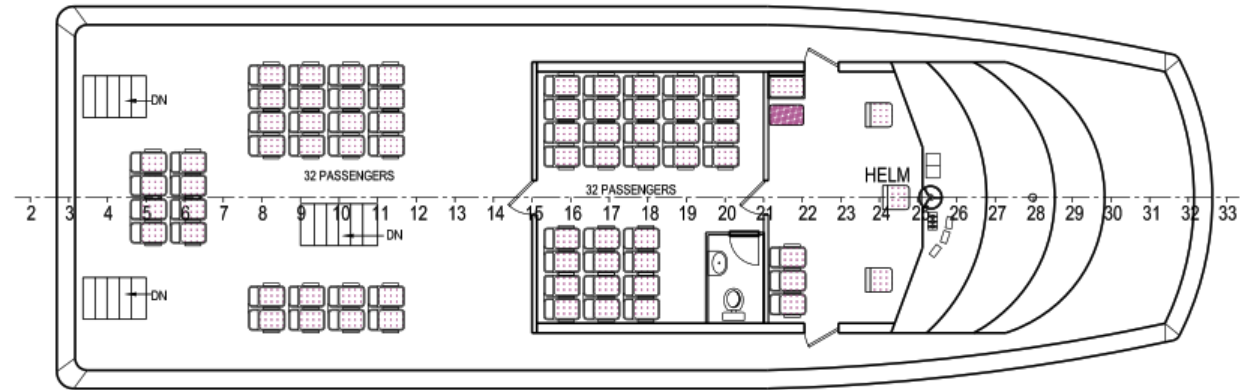

MAIN DECK PLAN

TECHNICAL SPECIFICATIONS

DIMENSIONS

Length: 40.0 m

Length at waterline: 37.20 m

Beam: 7.9 m

Draft: 2.20 m loaded

MACHINERY

Main Engines: 3 x Caterpillar C32 – 1,450 HP @ 2,100 rpm

Auxiliary Engines: 2 x 80 Kw Caterpillar, 440 volt 3 phase

Bow Thruster: 80 HP

Cooling System: Keel cooling

Exhausts: Wet

Batteries: 5 banks for main engines and generators, starting with one emergency bank above weather deck. Rotary colhersee switch to all

Compressor: General unit 12 cfm for servicing equipment

Tools: Frontline tools, equipment and testing tools for preventative maintenance and on-board breakdowns

PERFORMANCE

Maximum Speed: 27 knots @ 100% MCR

Cruising Speed: 25 knots @ 90% MCR

Economic Speed: 14 knots @ 40% MCR

Fuel Consumption: 20 litres/hour at anchorage

:430 litres/hour at economic speed

: 750 litres/hour at cruising speed

: 840 litres/hour at maximum speed

Range: 1,800 nautical miles (*with 10% reserve*)

CARGO CAPACITY

Deadweight: 70.0 tonnes

Deck Load: 10.0 tonnes

Deck Strength: 2.0 tons/m²

Clear Deck Area: 75.0 m²

Sewage: 1,000 litres sewage treatment plan

TECHNICAL SPECIFICATIONS

TANK CAPACITIES

Fuel for vessel: 50,000 litres

Potable water: 10,000 litres

PASSENGER ARRANGEMENTS

Air Conditioning: Split system with heating and cooling providing redundancy throughout the vessel

Bridge Deck: High back seating for 32 passengers in air-conditioning, exterior seating for 32 passengers, 1 x toilet, 1 x freshwater fountain, 1 x coffee machine, TV video with LCD screens

Upper Deck: High Back seating for 113 passengers in air-conditioning, 2 x toilets, 1 x freshwater fountain, 1 x coffee machine, TV video with LCD screens

Main Deck: 127 high back passenger seating, 1 x toilet, kiosk, TV video with LCD screens and dedicated cargo stowage area

CREW ARRANGEMENTS

Cabins: 2 x 2 crew, 2 x 1 person officers cabins with ensuites, 1 x 4 crew, all with lockable drawers, reading lights, privacy curtains, vertical lockers, power outlets, ladders to upper bunks

Showers and Toilets: 2 dedicated for crew

Bridge: Control helm, wing stations, office desk, 3 captain seats, 4 crew seats

Galley: Electric stove/oven, microwave. Fridge, freezer, storage room

Mess: Seating for 8 people

Broad Band Internet: KVH Tracphone

Sat Phone: 1 x Globalstar

Sat Fax: Yes

TECHNICAL SPECIFICATIONS

DECK AND HULL MISC.

Fendering: Half round rubbing strake

Stern Loading: Flush push up with landing area

Gangway: Portable aluminium gangway

Handling: Boat Hooks, Grapple with Lanyard

Deck Equipment: Recessed tie downs SWL 500 kgs

Mooring: Double Bit Bollards – 6 sets

Plating: 6.0 mm deck

Access to water: Transom and side rescue zones

Passenger Transfer: 1,350 mm from waterline

Anchor: 2 x 110 kg bow

Anchor Winches: 2 x Electric 5 ton

Anchor Chain: 2 x 110 metre

Pillar Deck Crane: 2.5 ton SWL at 6.0 m radius with hydraulic extension and winch

ELECTRONICS

Radar: Furuno 2 x FAR 2117

Sounder Furuno

Auto Pilot: Yes

Plotter: Furuno

GPS and DGPS: Furuno

VHF Radio: Icom IC 411

HF / SSB Radio: Icom IC M801E c/w AT 30 auto turner

Compass: Furuno SC50

Barometer and Clock: One each at main helm station

AIS: Simrad MX 535 A

Search Light: 2 x Sanshin HR-1012

Intercom: GME to machinery space, accommodation area, mess area and helm

Public Address: Raymarine 430 with 2 speakers in wheelhouse roof

Charts: All current charts for operational areas, hard copies and electronic

TECHNICAL SPECIFICATIONS

SAFETY EQUIPMENT

Fire Hoses and Nozzles: 3 sets with spray nozzles

Fire Hydrants: 3 stations

Fire Control Plan / Muster List: Class approved

General Emergency Alarm: Yes

Life Rafts: 6 x 100 and 2 x 50 man

Man Over Board Rings: 10 off, 2 with lights

First Aid Room: Main deck port side with stretcher and curtains

Solas Life Jackets: 320 Solas and 10 deck RFD work vests

Parachute Rocket Flares: 4 as per survey requirements

Hand Held Flares: 8 as per survey requirements

First Aid Kits: 1 x type E, 1 x Sutures kit

General Emergency Alarm: Yes

Fixed Fire Fighting System: Fitted in machinery spaces

Emergency Escape: Machinery spaces and accommodation

Fuel Shut Off: Remote operated

Fog Horn: Distress signalling type

LIGHTING

Navigation Lights: Port, Starboard, Masthead, Stern & Anchor. 1 x towing, 1 all-round white and 2 all-round red

Floodlights: 2 x forward and 2 x aft

Search Lights: 2 sets

Deck Lights: 6 units recessed

Navigation Lights: Class approved

Torches: 2 x Signalling

PUBLICATIONS

Stability Booklet: 2 sets approved by Classification Society

Operations Manual & Procedures: As approved by Classification Society

Vessel Log Book: To ISO/ISM requirements

CERTIFICATION

All vessels are constructed to IACS Classification under the applicable rules of the flag state of destination.



AMT
AUSTRALIAN MARINE TECHNOLOGY

Australian Marine Technology Pty Ltd
PO Box 655, Tugan 4224 Queensland, Australia
Email: info@mocshipyard.com Web: www.mocshipyard.com